



# **STONHARD**

**MANUFACTURER AND INSTALLER OF SEAMLESS,  
SANITARY FLOORS FOR FOOD & BEVERAGE FACILITIES**



## SEAMLESS FLOORS INFLUENCE SANITARY DESIGN FOR FOOD AND BEVERAGE ENVIRONMENTS

Stonhard is the food and beverage industry's trusted leader in manufacturing, installing, and supporting the full life of technically-advanced seamless resinous flooring, wall and lining systems.

**STONHARD**

## BENEFITS AT A GLANCE

---

TURNKEY SERVICE COVERING PRODUCTS TO INSTALLATION

---

WORLDWIDE RESOURCES WITH LOCAL AND DIRECT SALES

---

EXPERTLY TRAINED CREWS WORK DIRECTLY FOR STONHARD

---

GLOBAL LEADER IN INDUSTRY

---

PROJECT & DESIGN SUPPORT THROUGH OUR ARCHITECTURAL ENGINEERING GROUP

---

ENGINEERING-CERTIFIED SOLUTIONS AND REAL-TIME PROBLEM SOLVING

---

LARGEST RANGE OF HIGH-PERFORMANCE PRODUCTS WITH QUICK TURNAROUND

---

FLOOR TO CEILING TOTAL HYGIENIC SOLUTIONS

---

CUSTOM-DESIGN CAPABILITIES

---

UNPARALLELED SAFETY STANDARDS

---

ISO 9001 CERTIFIED | HACCP CERTIFIED | LEED CERTIFIED | EHEDG CERTIFICATION

---



With nearly a century of experience behind the Stonhard name, we combine extensive industry expertise with unparalleled levels of service and specialized products designed specifically for the unique requirements of the most demanding food and beverage environments around the world.

No one else offers the level of reliability, flexibility, consistency and longevity that Stonhard offers. We've never met a challenge we couldn't solve.

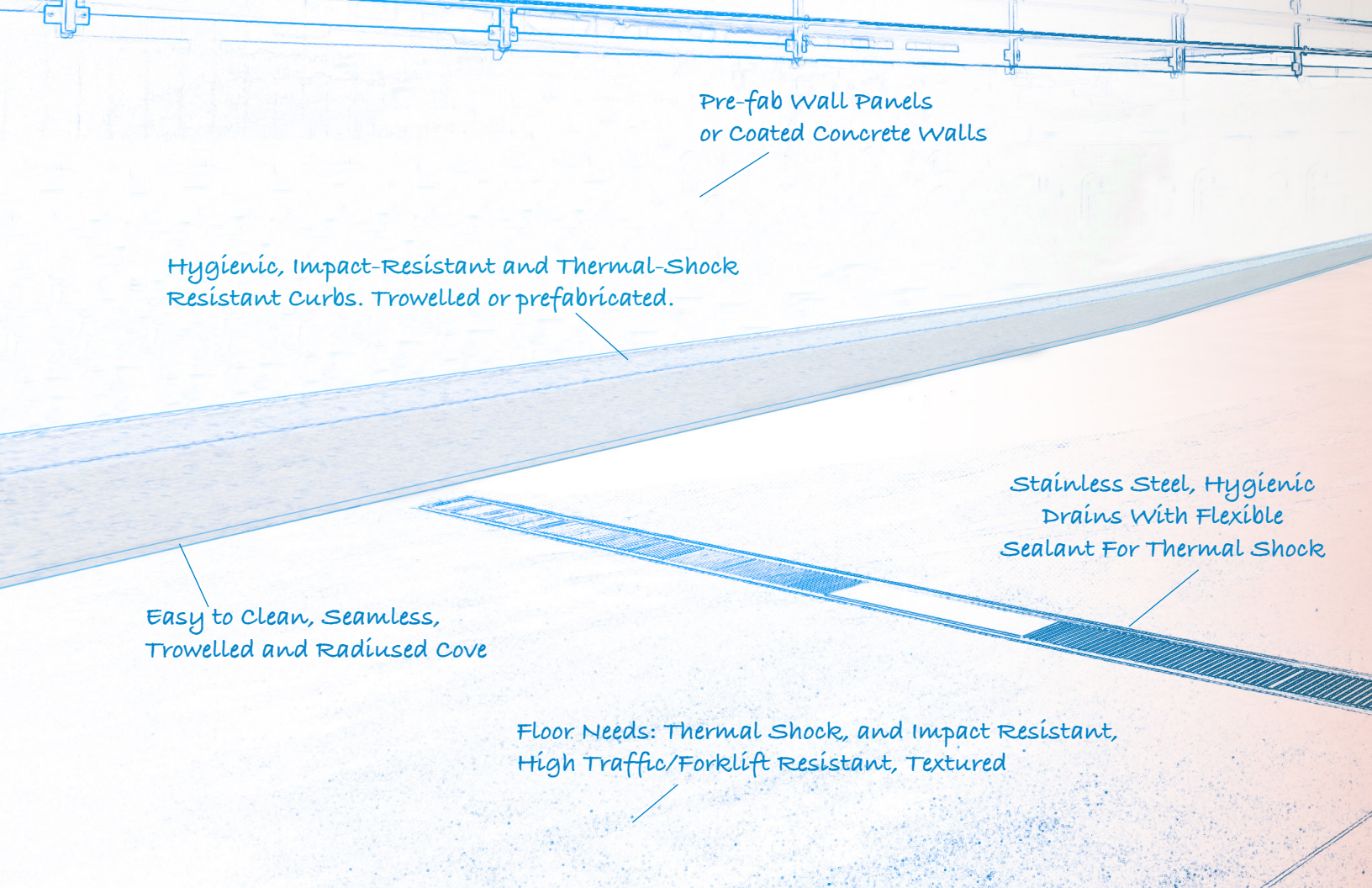

Pre-fab Wall Panels  
or Coated Concrete Walls

Hygienic, Impact-Resistant and Thermal-Shock  
Resistant Curbs. Trowelled or prefabricated.

Easy to Clean, Seamless,  
Trowelled and Radiused Cove

Stainless Steel, Hygienic  
Drains With Flexible  
Sealant For Thermal Shock

Floor Needs: Thermal Shock, and Impact Resistant,  
High Traffic/Forklift Resistant, Textured

## FROM DESIGN TO REALITY.

STONHARD IS THERE TO GUIDE YOU EVERY STEP OF THE WAY.

### Remove The Guesswork With Our Turnkey Solution

As one of the only turnkey seamless flooring solutions providers in the industry, Stonhard removes the guesswork for everything from small repairs to major plant renovations to brand-new builds. We work with you to design your facility's floor, wall and lining needs from start to finish, all under one roof.

What does that mean to you? It means product performance, because our products are manufactured in-house; more skilled installations by expert local teams; faster and more flexible service at every stage; and a flawless end result. Specializing in renovating old plants to new standards, we restore hygienic conditions for food safety and bacteria control.

### We Stand By Our Floors

Stonhard gives you a single-source warranty, but we go beyond that. When the installation is complete; we don't disappear, we stand by our floors. We believe in our relationships and are available on your schedule to support your facility.

**STONHARD**



### More Flexibility, Faster Speed of Service & Competitive Pricing

Trust: it's the reason so many customers return to us. Our teams of local experts and on-site engineers offer specialized consulting and real-time problem solving, so any changes that are needed can be addressed quickly and comprehensively. Our robust product offering and stocking and fulfillment capabilities ensure that everything, from minor tweaks to more substantial modifications can be properly accommodated while keeping your project on time and on budget.

### We Are Available When And Where You Need Us

Our flooring experts are dedicated to solving the toughest challenges in your facility. With global installation capacity, our crews are full-trained, safety-certified industry experts who take pride in delivering a wide range of specialized services, and are ready to go wherever you need them. We excel at challenging conditions, paying close attention to fine points like crack details, joints and caulking around drains for a flawless execution.

Local teams can be assembled on an as-needed basis and mobilized quickly to respond to changing needs. Territory Managers, Engineers and Architectural Engineering representatives are ready with industry-tailored solutions to respond to a wide range of challenges and site-specific concerns, including concrete and crack repair, sloping, thermal shock resistance, excessive movement and waterproofing.



## YOUR **SPACES**, OUR **FLOORS**.

WE DELIVER DURABILITY AND DESIGN FOR AREAS, FROM HOT TO COLD.

---

**BAKERIES**

**BREWERIES**

**BOTTLING LINES**

**CAFETERIAS**

**CHEMICAL STORAGE ROOMS**

**COOLERS**

**DAIRIES**

**FREEZERS**

**LABORATORIES**

**LOBBIES**

**MEAT PACKING**

**MIXING**

**PACKAGING**

**PROCESSING**

**TRAFFIC AISLES**

**WASH DOWN AREAS**

### Every Aspect Of Safety Matters To Us

It is our responsibility to ensure safety regulations and standards are met. This means from product ingredients to the installation itself, everyone on the Stonhard team is committed to the safety of your food and beverage environment. In addition to adhering to stringent guidelines our products are HACCP certified.

### We Understand Your Pain Points

Stonhard understands the biggest pain points and individual needs of your food and beverage facility, from our many years of experience and life-long relationships with our clients. We are able to offer a broad range of specialized advantages and skilled installation techniques particularly suited to the stringent operating conditions of food and beverage facilities such as:

- Custom-designed solutions to form & pour trenches and drains
- Superior sloping using urethane technology to create a fully thermal-shock-resistant floor
- Integral coving options available to suit any height requirement to create a seamless transition from floor to wall
- Close attention to engineering details such as crack treatment, chasing, trench details, caulking
- Slip-resistant textures available to protect against hazardous conditions
- On-site engineering-certified solutions for total quality control



## PRODUCT RECOMMENDATIONS: **LIGHT USE**

### STONSHIELD SLT

- High Strength
- Slip Resistant
- High Gloss
- Textured Finish

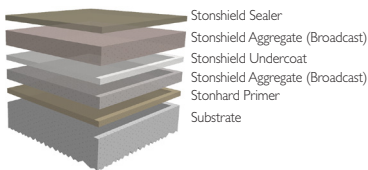

Stonshield SLT is a cost-effective, textured, decorative epoxy system with reduced resistance to heavy impact and loads. Ideal for light manufacturing and commercial environments including food prep areas, mixing areas, food storage, dish wash areas, kitchens and restrooms.

### STONSHIELD URT

- Abrasion Resistant
- Slip Resistant
- Wear Resistant
- High Gloss
- Textured Finish
- UV Resistant

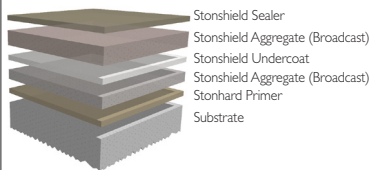

Stonshield URT combines a decorative appearance with excellent chemical, stain, wear resistance and light stability. This system creates a dense, stain resistant surface that can be installed with quick turn-around and low odour.

### STONTEC ERF

- High Gloss
- Decorative Flake Floor
- Stain Resistant
- Fast Installation

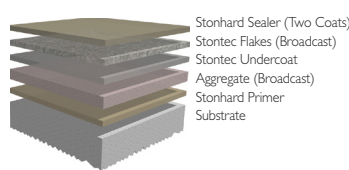

Stontec ERF is an epoxy system designed for use over smooth concrete. Ideal for healthcare, education environments, laboratories, process areas, retail, sports and entertainment venues, offices, laboratories, and washrooms.

### STONTEC UTF

- Abrasion Resistant
- Wear Resistant
- High Gloss
- Stain Resistant
- UV Resistant

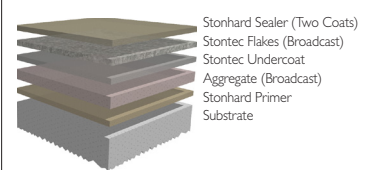

Stontec UTF is a urethane-based system that combines a decorative appearance with chemical, stain, and wear resistance. This system creates a stain-resistant surface that can be installed quickly with little odor.



## PRODUCT RECOMMENDATIONS: **MEDIUM USE**

### STONCLAD UL

- High Strength
- High Traffic
- Thermal Shock/Cycling
- High Gloss
- Smooth Finish

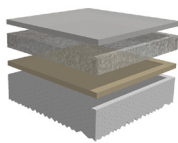

Stonhard Coating (Optional)  
Stonclad (Mortar)  
Stonhard Primer  
Substrate

Stonclad UL is a self-leveling, high-performance mortar system that has a smooth, matte finish and exhibits excellent wear resistance, impact resistance and chemical resistance. Stonclad UL is ideal for dry food processing areas and other quick-turn industrial applications or anywhere a tough, self-leveling mortar system is required.

### STONCLAD GS

- High Strength
- High Traffic
- High Gloss
- Textured Slip Resistance

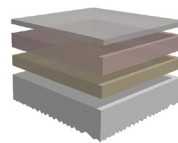

Stonhard Coating  
Broadcast Aggregate  
Stonclad (Mortar)  
Substrate

Stonclad GS is an epoxy mortar system providing excellent impact and abrasion resistance, and chemical resistance and stands up to traffic. It is a high performance floor ideal for traffic aisles, packaging areas and warehouses in food and beverage facilities.





## PRODUCT RECOMMENDATIONS: **HEAVY USE**

### STONCLAD UT

- High Strength
- High Traffic
- Thermal Shock/Cycling
- High Gloss
- Textured Slip Resistance

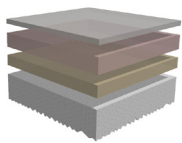

Stonhard Coating  
Broadcast Aggregate  
Stonclad (Mortar)  
Substrate

Stonclad UT gives the added texture required in many large and small food and beverage companies. Due to its resistance to harsh and continuous chemical attack, impact and abrasion, Stonclad UT has the ability to stand up to thermal cycling and thermal shock.

### STONSHIELD UTS

- High Strength
- Thermal Shock/Cycling
- Wear Resistant
- Textured Slip Resistance
- Fast Installation
- UV Resistant

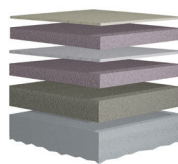

Stonseal CA7  
Stonshield Aggregate (Broadcast)  
Stonseal CA7  
Stonshield Aggregate (Broadcast)  
UTS Mortar  
Substrate

Stonshield UTS is a self-priming, high-gloss, textured system that cures to an extremely hard, high impact-resistant surface which is decorative and exhibits excellent abrasion, wear, temperature and chemical resistance.

### STONCLAD HT

- Chemical Resistant
- High Strength
- High Traffic
- High Gloss
- Smooth Finish

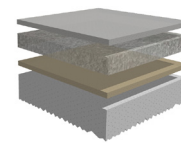

Stonhard Coating (Optional)  
Stonclad (Mortar)  
Stonhard Primer  
Substrate

Stonclad HT cures to an extremely hard, impact-resistant mortar which exhibits excellent abrasion, wear resistance and superior chemical resistance. It can be used anywhere chemical-resistant epoxy mortar is required.



## MORE THAN FLOORS - COMPLETE SANITARY DESIGN WITH LININGS, WALL SYSTEMS, DRAINS AND PROTECTIVE WALL CURBS

---

### STONGLAZE WALL SYSTEMS

- High Gloss
- Smooth Finish
- Seamless Wall Protection
- Durable, Puncture-Resistant Wall Surface
- Long-term Abrasion and Chemical Resistant
- Stain Resistant
- Easy-To-Clean Glaze Finish

Smooth and seamless, our wall systems resist splashes, spills, fumes and abrasion. Stonglaze formulations can be applied over concrete, block cement board or drywall and are expressly designed for sanitary environments. Stonglaze wall systems have a polished appearance and are hard wearing for even the most rigorous settings. Recommended for all food & beverage areas including food processing areas, breweries, wineries, restrooms, and commercial kitchens.

### STONCHEM LINING SYSTEMS

- Heavy-duty Corrosion Resistant
- Abrasion Resistant
- Chemical Resistant
- High Strength
- High Traffic
- Wear Resistant

Stonchem is a range of high-performing resin chemistries providing exceptional lining protection for ultra-corrosive environments and perform under extreme physical conditions. Stonchem is ideal for concrete pads, CIP areas, trenches, concrete pads, etc. The Stonchem product line leads the industry in protection for secondary containment, processing areas, chemical storage and battery rooms.

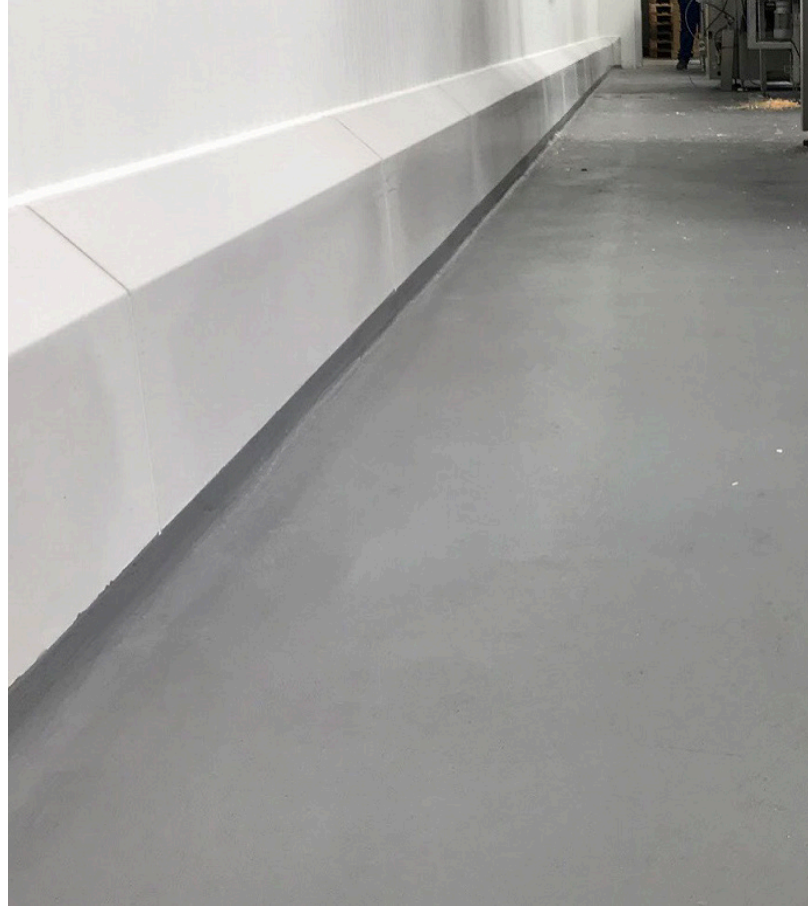

## PRODUCT RECOMMENDATIONS: **TOTAL HYGIENIC SOLUTIONS**

---

### **BLÜCHER DRAINS**

Recommended Areas:

- Food Processing, Beverage Processing
- Packaging
- Food Production, Beverage Production
- Traffic Aisles
- Meat Packing
- Bottling Lines
- Washdown Areas

Stonhard has partnered with Blücher, a world-leading producer of EHEDG-certified, stainless steel, sanitary drainage systems to provide our customers with the most complete, hygienic solutions available. This all-stainless steel drainage systems ensure excellent flow capacity and optimum hygiene along with minimum maintenance.

### **POLYSTO PROTECTIVE SANITARY CURBS**

Recommended Areas:

- Food Processing, Beverage Processing
- Packaging
- Food Production, Beverage Production
- Traffic Aisles
- Meat Packing
- Bottling Lines
- Chemical Storage, Warehouse Storage

Stonhard is the exclusive provider of EHEDG-certified PolySto hygienic curbs to offer the best solutions to our food & beverage clients. PolySto, the leading producer of hygienic wall protection for the food and beverage industry, manufactures prefabricated, polymer composite curbs to provide wall protection at a higher level than those composed of concrete. Both Stonhard floors and PolySto curbs are chemical resistant, water resistant, and easy to clean.

STONHARD is a global leader in manufacturing and installing seamless floor, wall and lining systems with sales operations in more than 65 countries.



# STONHARD®

## Stonhard Worldwide

Maple Shade, NJ, USA HQ  
(800) 257 7953

Whitby, Ontario, Canada  
(800) 263 3112

Mexico City, Mexico  
+(52) 55 9140 4500

Buenos Aires, Argentina  
+(54) 11 5032 3113

Nivelles, Belgium  
+(32) 67 49 37 10

Dubai, U.A.E.  
+(971) 4 3470460

Johannesburg, South Africa  
+(27) 11 254 5500

Shanghai, China  
+(86) 21 61838698

Melbourne, Australia  
+(61) 3 9587 7433

Mumbai, India  
+(91) 22 28500321

**STONHARD.COM**

Stonhard believes the information contained here to be true and accurate. Stonhard makes no warranty, expressed or implied based on this literature and assumes no responsibility for consequential or incidental damages in the use of these products and systems described, including any warranty of merchantability or fitness. Information contained here is for evaluation only. ©2020.

